

**WEST SUBURBAN CONFERENCE
BOYS & GIRLS SILVER CROSS COUNTRY CHAMPIONSHIP MEET
SATURDAY, OCTOBER 19, 2013
HOSTED BY PROVISO WEST HIGH SCHOOL**

TO: GIRLS CROSS COUNTRY HEAD COACH
BOYS CROSS COUNTRY HEAD COACH

FROM: CALVIN DAVIS, ATHLETIC DIRECTOR

HOST COACHES: NEFETERI OKINE – BOYS CROSS COUNTRY
PEGGY WHITLOW – GIRLS CROSS COUNTRY
MICHAEL BRAZIER - MEET MANAGER AND CONTACT PERSON

INRE: WSC BOYS & GIRLS SILVER CROSS COUNTRY CHAMPIONSHIP MEET

RACE DATE: SATURDAY, OCTOBER 19, 2013

PLACE: PROVISO WEST HS

TIME: RACES WILL BE RUN ACCORDING TO THE SCHEDULE BELOW
A FIVE (5) MINUTE HORN WILL SOUND BEFORE THE START OF
EACH RACE

10:00AM	FRESHMAN GIRLS	3:04 MILES
10:45AM	FRESHMAN BOYS	3:04 MILES
11:30AM	SOPHOMORE GIRLS	3.04 MILES
12:00PM	SOPHOMORE BOYS	3.04 MILES
12:30PM	VARSITY GIRLS	3.04 MILES
1:00PM	VARSITY BOYS	3.04 MILES
1:30PM	JV GIRLS	3.04 MILES
2:00PM	JV BOYS	3.04 MILES

COURSES: MAP INCLUDED

**TIMER/
SEEDING** **FRED KREPPERT = fred@kompusport.com**

AWARDS: VARSITY – TOP 16 CONFERENCE MEDALISTS
LOWER LEVELS – TOP 16 RIBBONS

**RULES OF
CONDUCT:** THE MEET WILL BE CONDUCTED IN ACCORDANCE WITH THE IHSA TERMS
AND CONDITIONS

PACKETS: TEAM PACKETS WILL BE AVAILABLE ON THE DAY OF MEET

**RESULTS &
ENTRY
TO MEET**

WILL BE AVAILABLE AT THE COMPLETION OF THE MEET OR AT **WWW.KOMPUSPORTS.COM** ENTRY INSTRUCTION ATTACHED
ENTRY DEADLINE IS TUESDAY, OCTOBER 15 AT NOON

TRAINER:

OUR TRAINER WILL BE ON THE PREMISES DURING THE MEET

T-SHIRTS:

LONG SLEEVED SHIRTS WILL BE AVAILABLE FOR SALE

CONCESSIONS:

WILL BE PROVIDED BY THE PROVISO WEST BOOSTER CLUB

PARKING:

SCHOOL BUSES SHOULD PARK IN THE NORTH PARKING LOT (HARRISON STREET AND WOLF ROAD GATE) AFTER THEY HAVE UNLOADED THEIR TEAMS IN THE SOUTH PARKING LOT (CIRCLE DRIVE - ENTRANCE ON WOLF ROAD). PARKING LOTS ARE LOCATED ON THE NORTH AND SOUTH SIDE OF SCHOOL'S MAIN ENTRANCE ON WOLF ROAD.

BATHROOMS:

STADIUM BATHROOMS AND FIELDHOUSE HALLWAY BATHROOMS ARE AVAILABLE

WEATHER:

IF THE WEATHER SHOULD CHANGE PLEASE GO TO YOUR BUS OR THE FIELDHOUSE

**IF YOU HAVE ANY QUESTIONS CONTACT MICHAEL BRAZIER AT
SCHOOL 708/ 202-6383- CELL 630/234-6058**

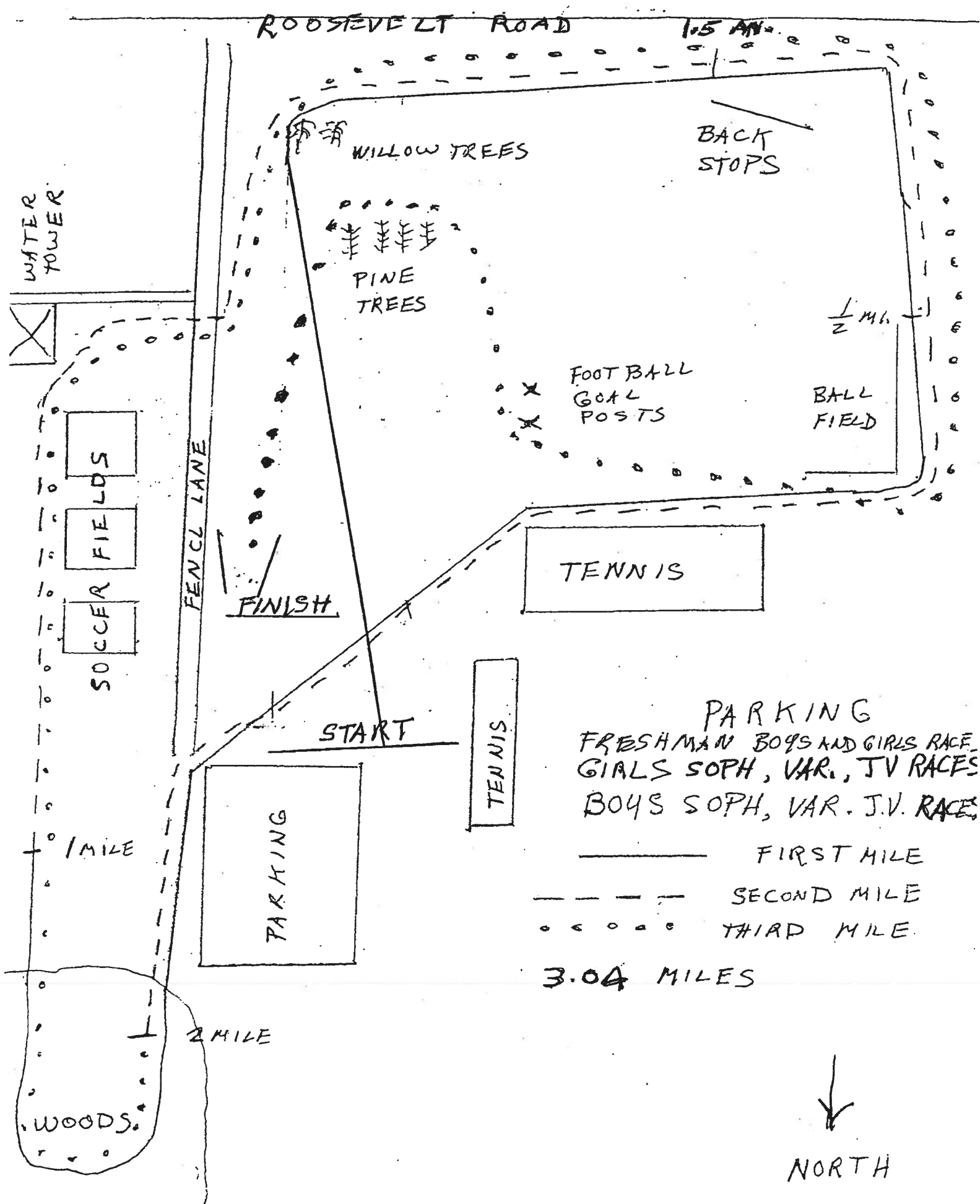

WATER TOWER

ROOSEVELT ROAD

1.5 AN.

WILLOW TREES

BACK STOPS

PINE TREES

1/2 MI.

FOOTBALL GOAL POSTS

BALL FIELD

FENCE LANE

FINISH

TENNIS

START

TENNIS

PARKING

PARKING

FRESHMAN BOYS AND GIRLS RACE
GIRLS SOPH, VAR., JV RACES
BOYS SOPH, VAR. J.V. RACES

1 MILE

FIRST MILE

SECOND MILE

THIRD MILE

3.04 MILES

2 MILE

WOODS

NORTH